

# PECIFICATION OF SAW FILTER

YOKETAN CORP.

Spec no: SIP5DF-00440-006-NJ-A

## 1. Features

IF Filter for Digital Cable TV

Plastic Package

## 2. Type : SIP5D

## 3. Product Dimension

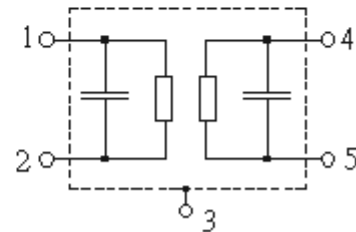
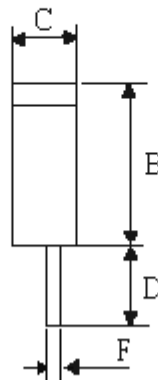
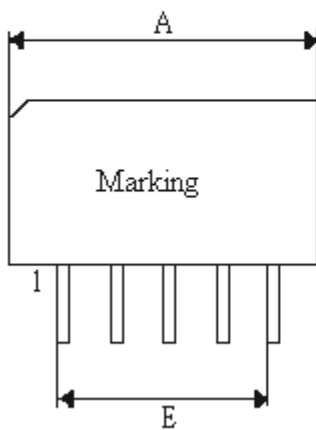
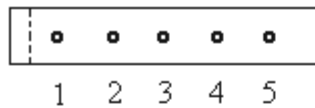

Pin	Configuration
1,2	Input
4,5	Output
3	Chip carrier- ground

Sign	Data ( unit: mm)	Sign	Data( unit: mm)
A	14.5±0.2	E	2.54 (x4)
B	5.8±0.2	F	0.3±0.2
C	2.8±0.2		
D	4.0±0.2		

# SPECIFICATION OF SAW FILTER

YOKETAN CORP.

## 4. Performance

### 4-1. Maximum Ratings

Rating	Value
Operable Temperature Range $T_A$	-25 to +65
Storage Temperature Range $T_{stg}$	-40 to +85
DC Voltage (between any terminals) $V_{DC}$	5V
AC Voltage (between any terminals) $V_{pp}$	10V

### 4-2. Electronic Characteristics

Reference temperature:  $T_A = 25(45) ^\circ C$   
 Terminating source impedance:  $Z_S = 50 \Omega$   
 Terminating load impedance:  $Z_L = 2 \text{ k}\Omega \parallel 3 \text{ pF}$

Item	Min	Typ.	Max.	Unit
Center Frequency (Center between 3dB points) $f_c$	--	44.00	--	MHz
Insertion attenuation $IL$ Reference level for The following data 44.06(44.00) MHz	13.2	14.7	16.2	dB
Pass bandwidth				
rel 3dB $BW_{3dB}$	--	6.0	--	MHz
rel 30dB $BW_{30dB}$	--	7.6	--	MHz
Amplitude ripple 41.35... 46.59 MHz	--	0.4	--	dB
Relative attenuation rel				
41.53(41.47) MHz	--	0.3	--	dB
46.59(46.53) MHz	--	0.4	--	dB
41.06(41.00) MHz	1.5	2.7	3.8	dB
47.06(47.00) MHz	1.8	3.0	4.2	dB
47.31(47.25) MHz	--	8.3	--	dB
39.81(39.75) MHz	40.0	55.0	--	dB
Lower sidelobe				
35.06 ... 39.46 (35.00 ... 39.40) MHz	43.0	47.0	--	dB
39.46 ... 40.06 (39.40 ... 40.00) MHz	38.0	47.0	--	dB
Upper sidelobe				
48.06 ... 50.06 (48.00 ... 50.00) MHz	37.0	42.0	--	dB
50.06 ... 55.06 (50.00 ... 55.00) MHz	43.0	51.0	--	dB
Group delay ripple (p-p) $\tau$ 41.53 ... 46.59 MHz	--	30	--	ns
Temperature coefficient of frequency $TC_f$	--	-72	--	ppm/K

# SPECIFICATION OF SAW FILTER

YOKETAN CORP.

## 5. Frequency Response

