

PECIFICATION OF SAW FILTER

YOKETAN CORP.

Spec no: SIP5DF-00361-008-NJ-A

1. Features

IF Filter for Digital Cable TV
Plastic Package

2. Type : SIP5D

3. Product Dimension

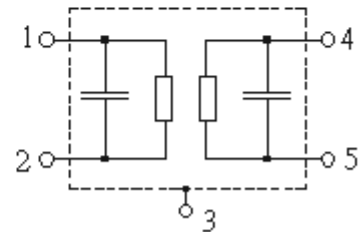
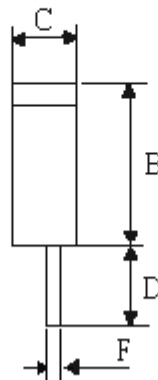
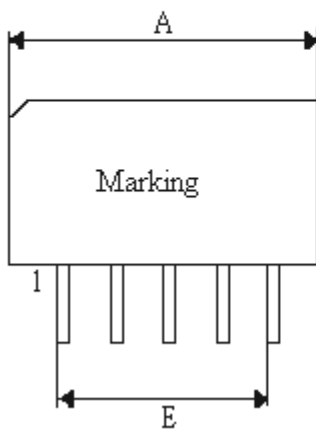
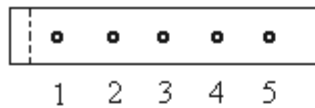

Pin	Configuration
1,2	Input
4,5	Output
3	Chip carrier- ground

Sign	Data (unit: mm)	Sign	Data(unit: mm)
A	14.5±0.2	E	2.54 (x4)
B	5.8±0.2	F	0.3±0.2
C	2.8±0.2		
D	4.0±0.2		

SPECIFICATION OF SAW FILTER

YOKETAN CORP.

4. Performance

4-1. Maximum Ratings

Rating		Value
Operable Temperature Range	T_A	-25 to +65
Storage Temperature Range	T_{stg}	-40 to +85
DC Voltage (between any terminals)	V_{DC}	5V
AC Voltage (between any terminals)	V_{pp}	10V

4-2. Electronic Characteristics

Reference temperature: $T_A = 25\text{ }^\circ\text{C}$
 Terminating source impedance: $Z_S = 50\ \Omega$
 Terminating load impedance: $Z_L = 2\ \text{k}\Omega \parallel 3\ \text{pF}$

Item		Min	Typ.	Max.	Unit
Center Frequency (Center between 10dB points)	f_c	36.070	36.125	36.180	MHz
Insertion attenuation Reference level for The following data	IL 36.13 MHz	18.8	20.3	21.8	dB
Pass bandwidth					
rel 1dB	BW_{1dB}	--	7.5	--	MHz
rel 3dB	BW_{3dB}	--	8.0	--	MHz
rel 30dB	BW_{30dB}	--	8.4	--	MHz
Relative attenuation	rel				
	32.32 MHz	--	1.2	--	dB
	39.93 MHz	0.1	1.1	2.1	dB
	32.13 MHz	1.9	3.1	4.3	dB
	40.13 MHz	2.0	3.2	4.4	dB
	31.25 MHz	35.0	50.0	--	dB
	47.25 MHz	42.0	50.0	--	dB
Lower sidelobe	25.00 ... 31.25 MHz	32.0	40.0	--	dB
Upper sidelobe	40.90 ... 50.00 MHz	30.0	38.0	--	dB
Temperature coefficient of frequency	TC_f	--	-72	--	ppm/K

5. Frequency Response

